

Unwinding with Fiber and Fabric

Pioneerlady at Pithyponderings

Basic Quilt Blocks

12" blocks

Bright Hopes Twist

Pithy Projects

12" Block 22" Quilted Pillow

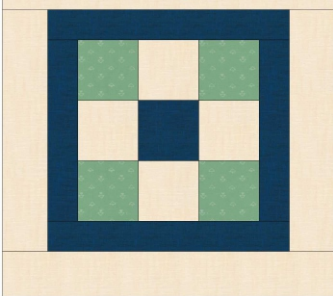

Piecing a quilt is just a matter of sewing pieces of fabric together into blocks, and then sewing blocks together until you have a quilt in your desired size and shape.

While simple, it can be intimidating when you are just beginning. Often the intimidation comes from not seeing where the basic block is located. Some blocks will create secondary designs that may look fabulous, but will make it difficult to identify the component parts.

Learning how to identify the components will make it easier to design your own quilts. Quilt blocks - the component parts of a quilt - can be made in any size, but some sizes are easier to calculate and cut out.

Beginning quilters might find that 12 inch finished blocks are a great place to start. Many blocks can be made to finish at 12" square. In the case of the blocks I will be sharing, some of the quilt blocks are in a 9-Patch grid and others in a 18-Patch grid.

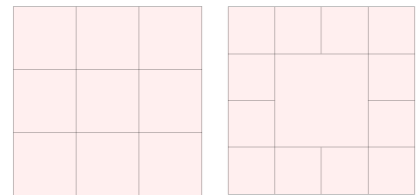

Working with 3.5" and 4.5" pieces allows a project to come together more quickly than working with smaller pieces. Many find the cutting and sewing of these sized

pieces to be easier when they are learning the new skills. Plus most batting can be hold up to quilting spaced as far apart as 4". These grid based blocks make it easy to finish the quilt using 'stitch in the ditch' or ties. So the beginning quilter, can finish a small quilt rather quickly.

12" Block 22" Quilted Pillow

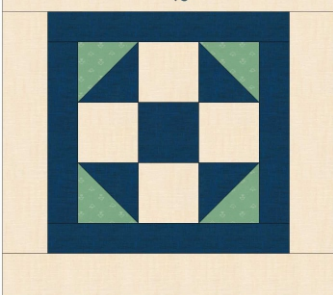

12" Block 22" Quilted Pillow

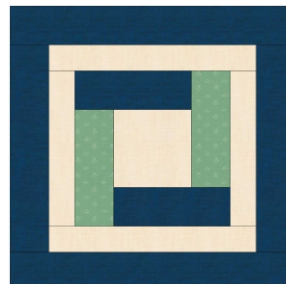
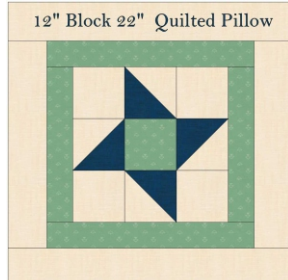

12" Block 22" Quilted Pillow

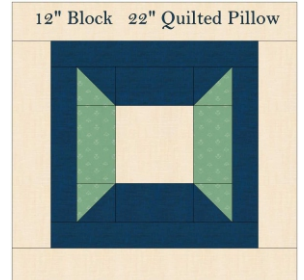

Pithy Projects

Bright Hopes Twist

by Pioneerlady at Pithyponderings

Materials Needed for Pillow Top



(2) 3.5" x 9.5" pieces



1/4 Yard of Fabric

(2) 3.5" x 9.5" pieces

(2) 3.5" x 16.5" borders***

(2) 3.5" x 22.5" borders***



1/2 Yard of Fabric

(1) 6.5" x 6.5" piece

(2) 2.5" x 12.5" borders***

(2) 2.5" x 16.5" borders***

Batting and backing fabric for quilting of pillow top.

Plus fabric for back of pillow.

Using a 1/4" seam allowance, begin sewing pieces together. Sew pieces into row and then sew the rows together.

Then add first set of borders on each side. Next add borders on top and bottom. Repeat for next borders.

***Note, I tend to add top and bottom borders first, although this diagram/pattern does the sides first. There is no rule on this, but checking your border measurements before cutting them is important. I always wait to cut my borders to size until after I finish piecing the body of the quilt.

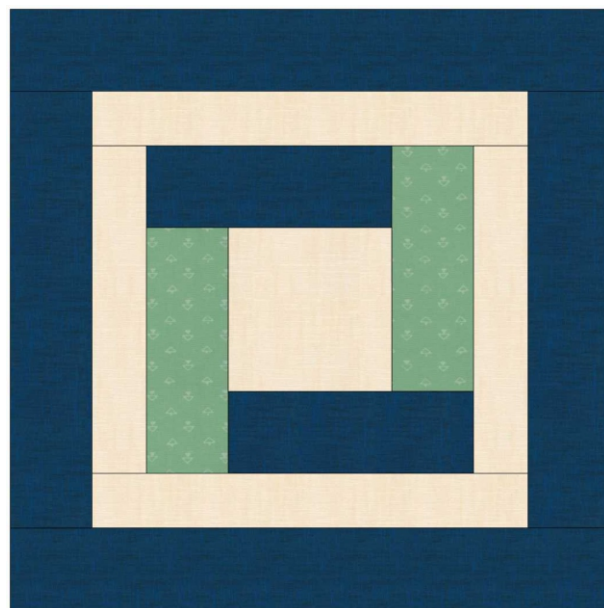

Overall pillow size finished is 22" x 22"



On the next page, there will be visual diagrams showing the order I use to sew my pieces into a block and the pillow top.

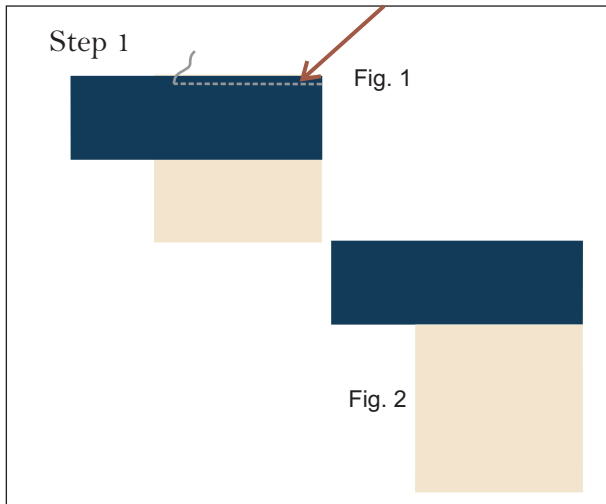

Fig. 1 - Sew 1st dark rectangle to light square, but stop sewing 1/4" from the edge.

Fig. 2 - Finger press the open the seam.

Fig. 3 - Apply the medium rectangle to the light square

Fig. 4 - Press open medium rectangle.

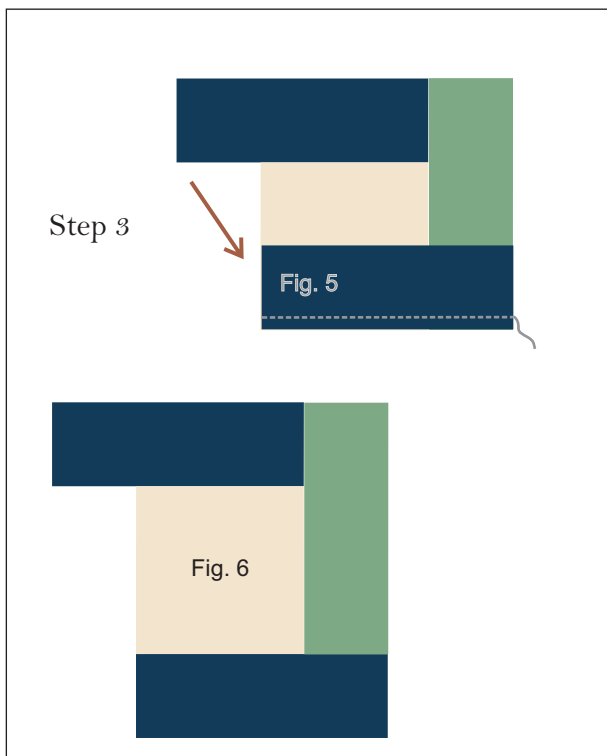
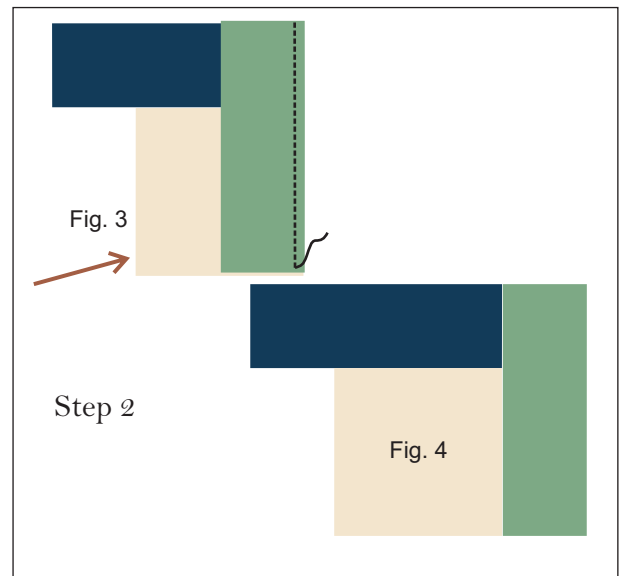

Fig. 5 - Sew next dark rectangle to the light square.

Fig. 6 - Press open seam.

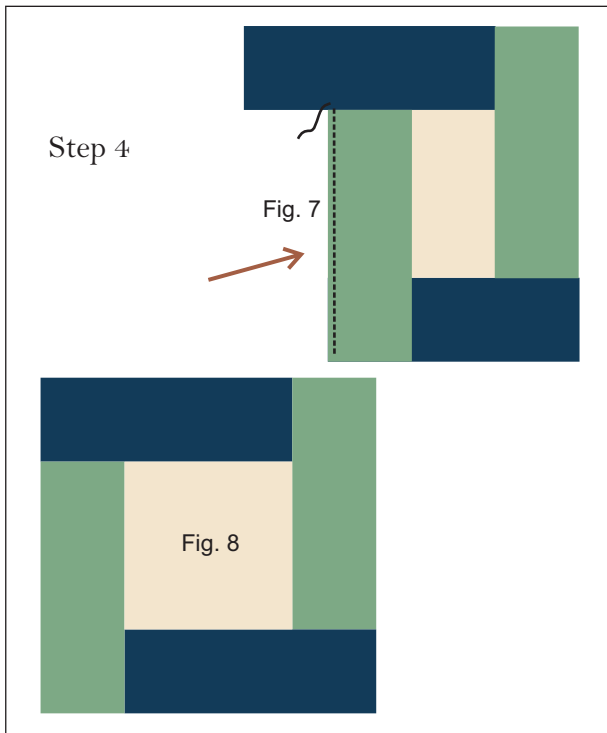
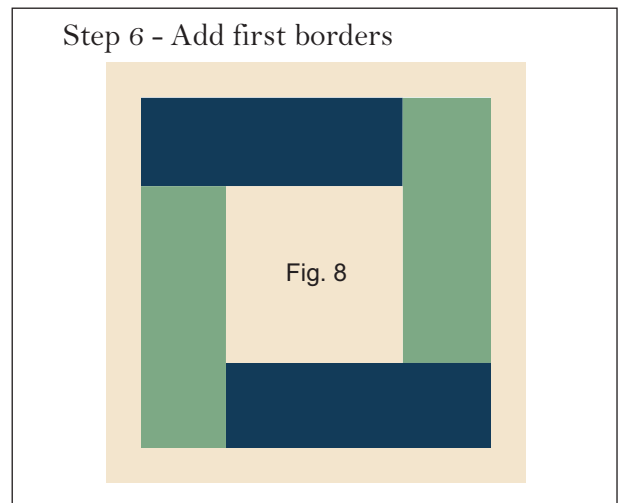
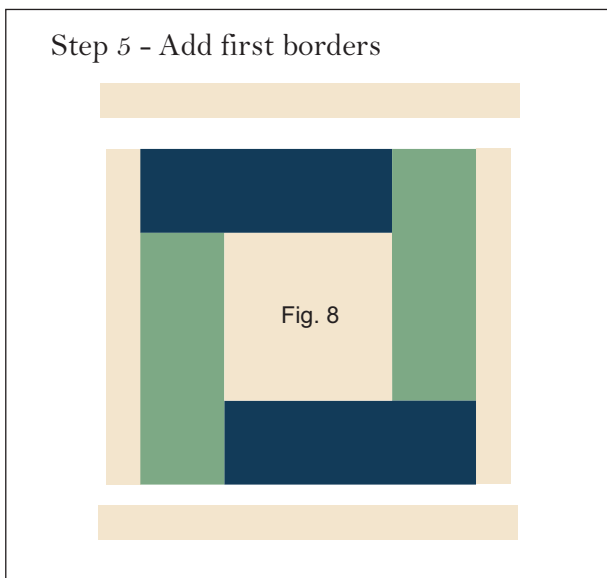

Fig. 7 - Apply the final medium rectangle sewing. Press open seam.

Fig. 8 - finish sewing the 1st dark rectangle to the new medium rectangle. Press open seam.



Add final border strips in the same manner as steps 5 and 6.

Bright Hopes Twist with Sashing Baby Quilt

by Pioneerlady at Pithyponderings

Materials Needed



You will need (4) of these blocks.



3/4 Yard of Fabric

- (4) 6.5" x 6.5" pieces
- (4) 2.5" x 12.5" sashing
- (2) 2.5" x 26.5" borders
- (2) 2.5" x 30.5" borders



3/4 Yard of Fabric

- (8) 3.5" x 9.5" pieces
- (2) 3.5" x 30.5" borders
- (2) 3.5" x 36.5" borders



1/2 Yard of Fabric

- (4) 4.5" x 4.5" pieces
- (1) 2.5" x 2.5" piece sash center
- (2) 2.5" x 36.5" borders
- (2) 2.5" x 40.5" borders

You will also need batting and backing fabric.

You will want 44" of backing fabric.

Plus fabric for binding (about 1/2 yard).

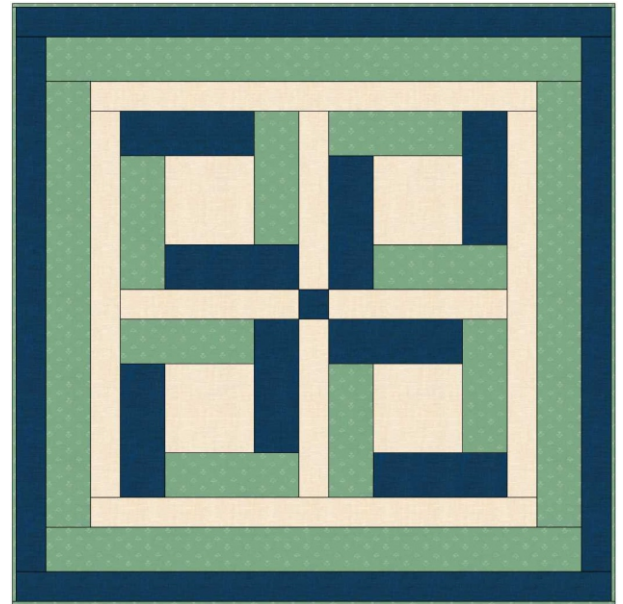

Overall Quilt size finished is 40" x 40"

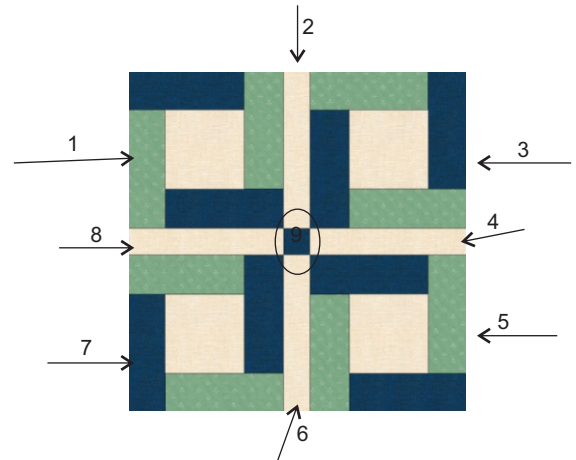

While at first glance this quilt may not look like it is nine blocks, just like the previous quilt it is has 9 components that will need to be sewn together.

4 of the pieces are large blocks, and 5 of the pieces are sashing and the center sashing square.

You will want to make the 4 Bright Hopes Twist blocks first before cutting your sashing.

Measure the blocks and adjust the length of the sashing to match your block measurements. Aim for the average. This is a good technique to use if your blocks don't exactly match in size.

*****All calculations assume you are using fabric that measures at least 42"*****