

Pithy Projects

Hand Piecing Project

by Pioneerlady at Pithyponderings

Wagon Wheel

Finished Block 10" Square

This hexagon block has been called the Wagon Wheel in the past, but when made with wintry fabrics it turns into an ice crystal.

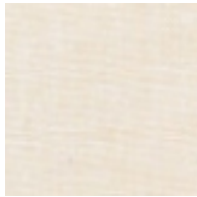
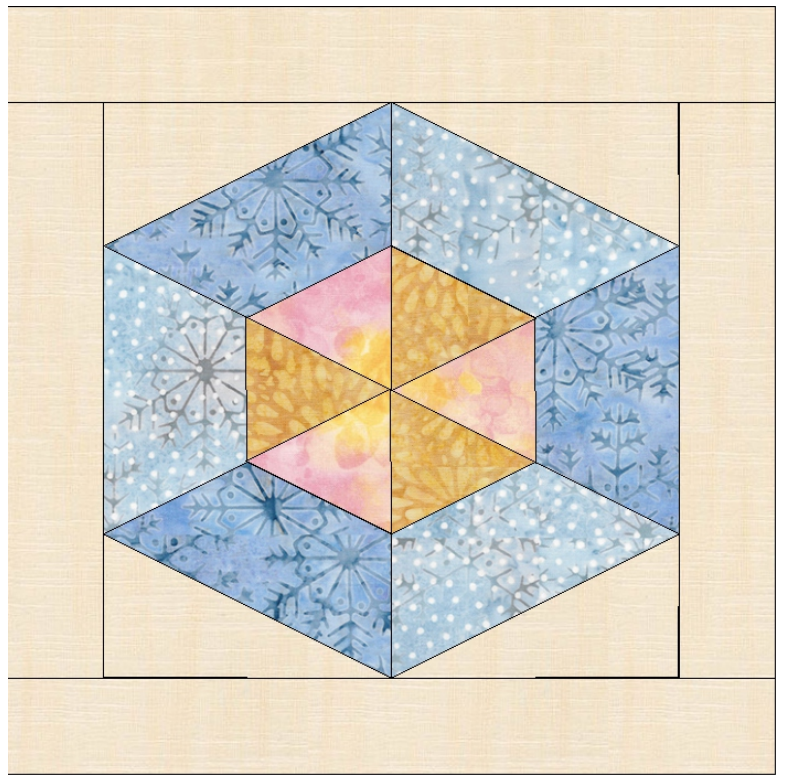

A



B



C

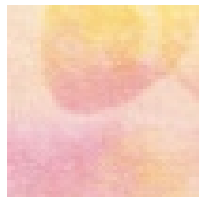

D



E

1/4 will be needed for fabric A.

1/8 yard cut of fabric will be enough for fabrics B, C, D, E.

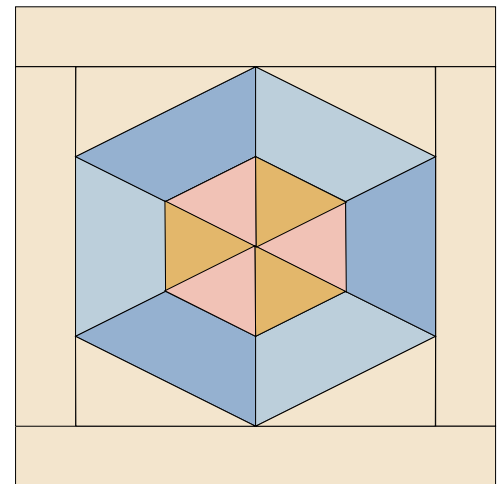
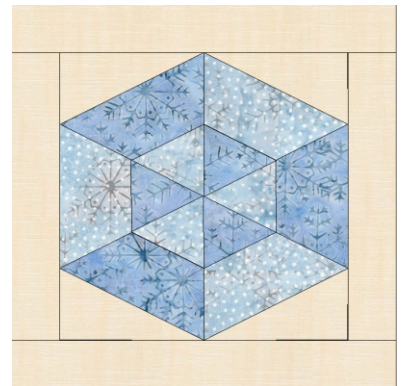

All template pieces on the following pages are drawn without seam allowances.

I have provided templates in color and in outline. You can use whichever you choose.

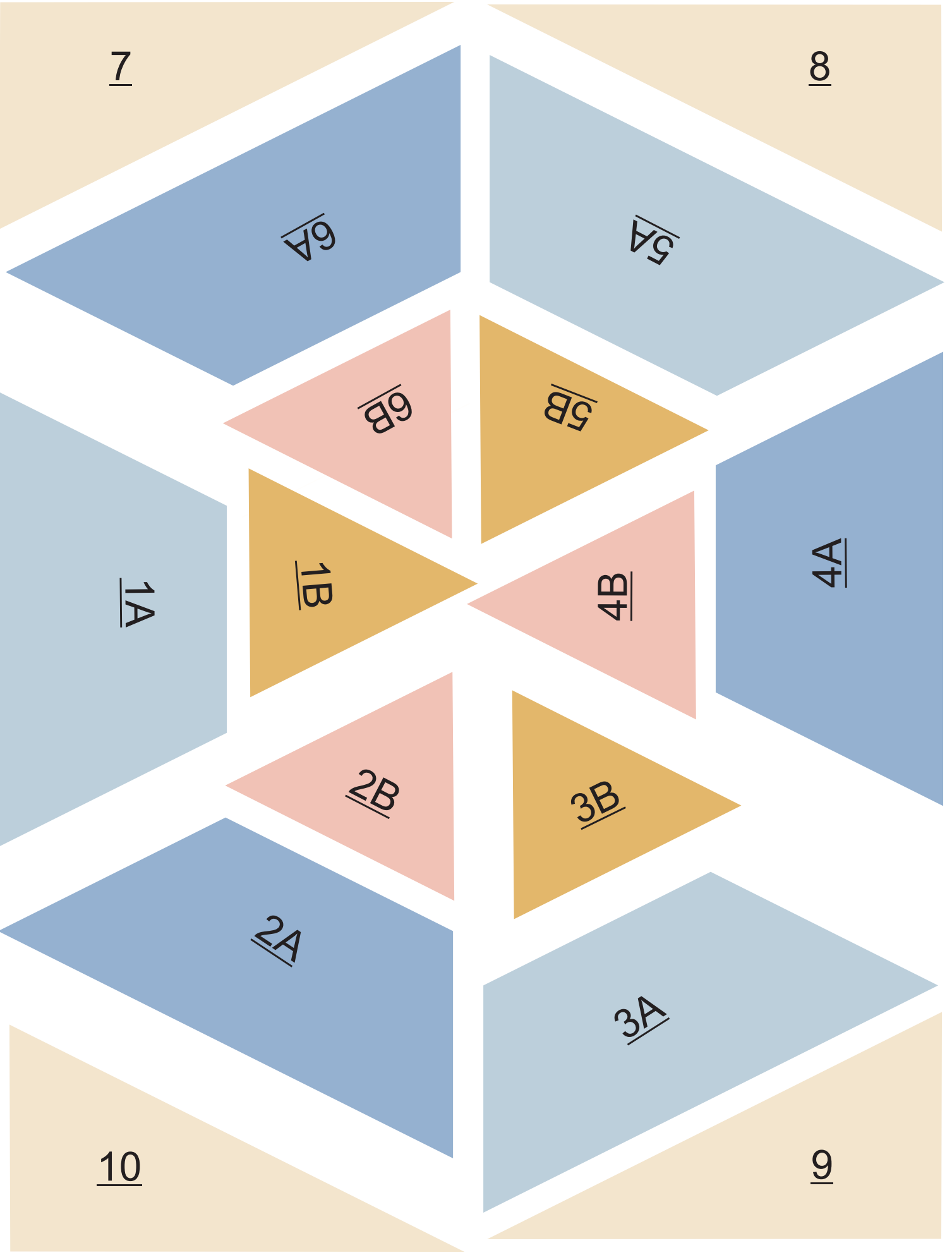

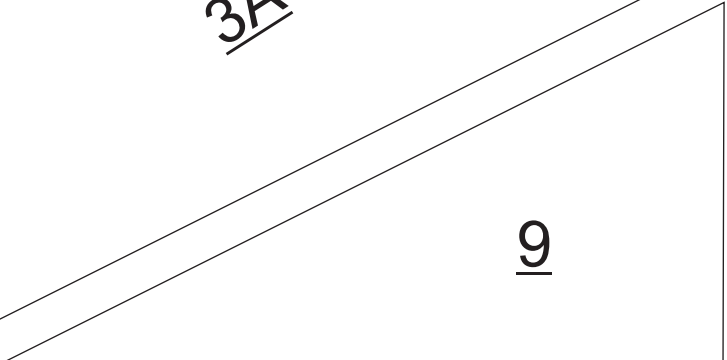
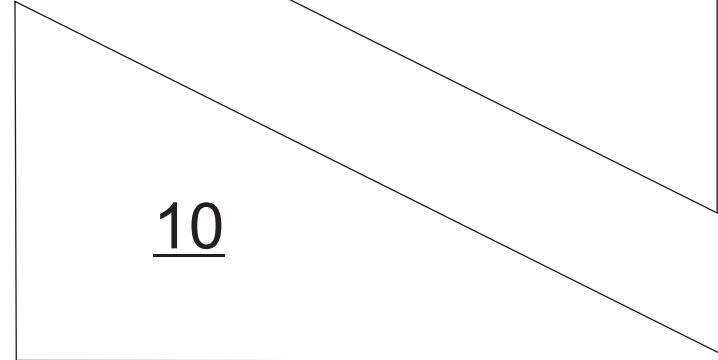
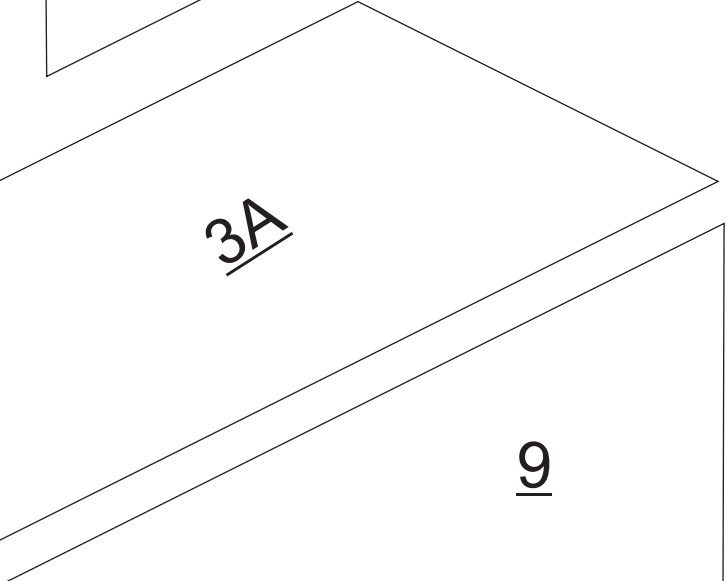
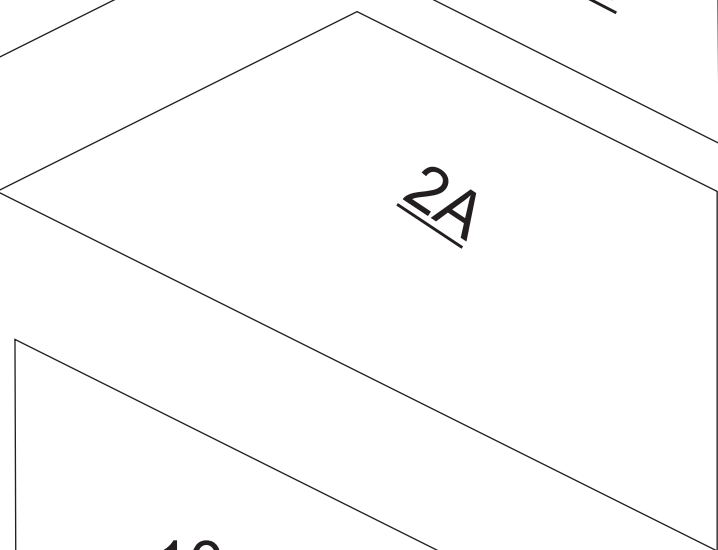
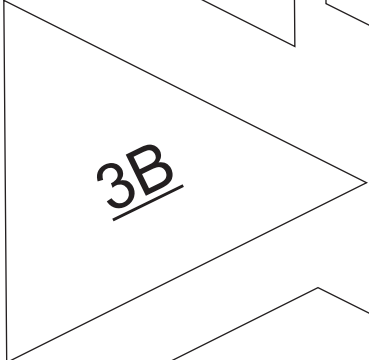
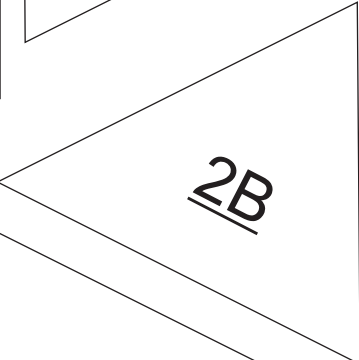
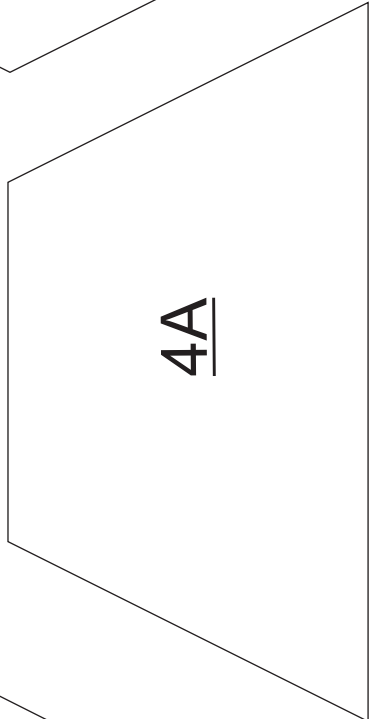
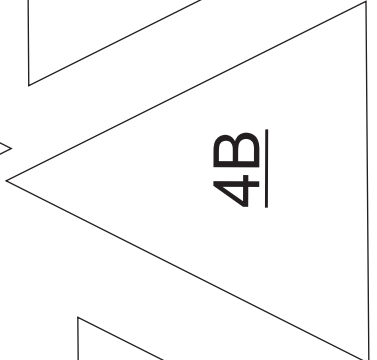
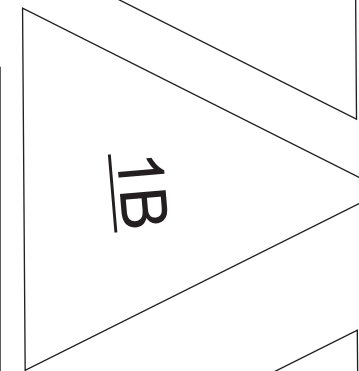
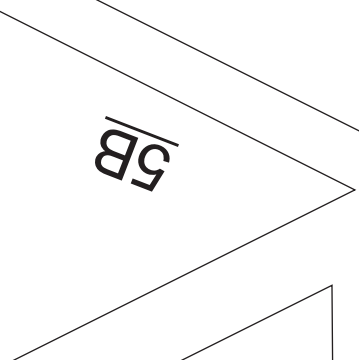
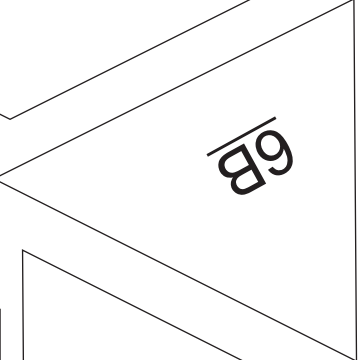
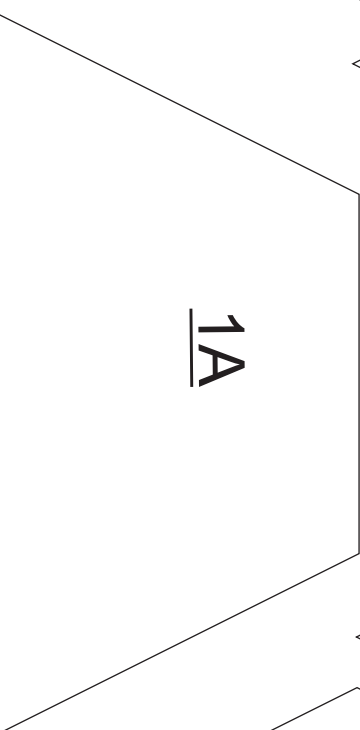
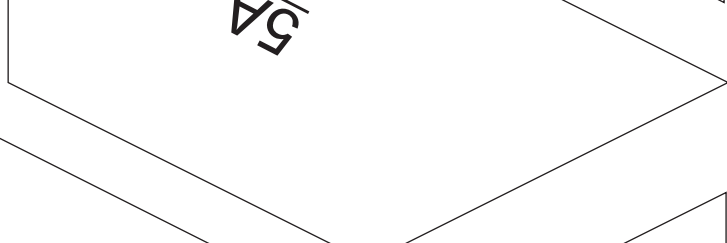
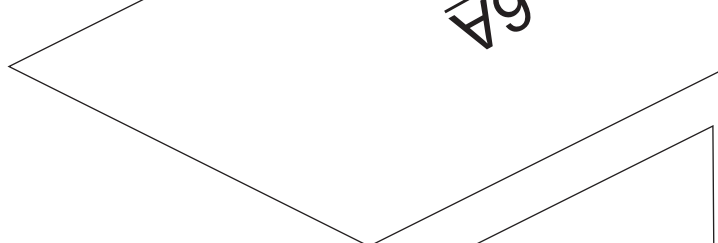
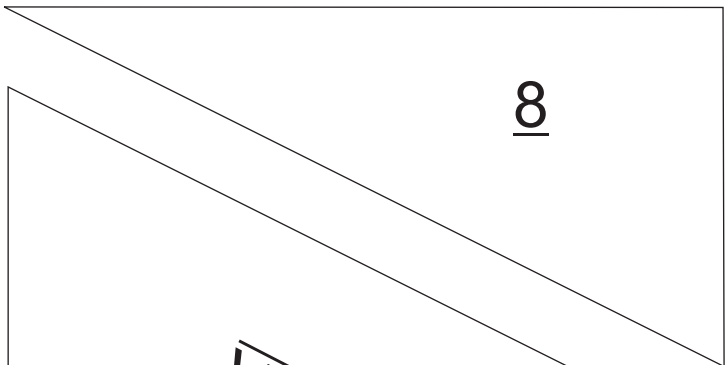

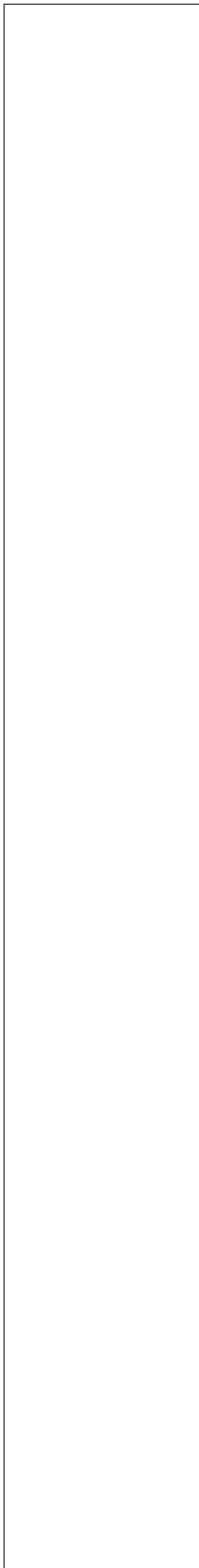
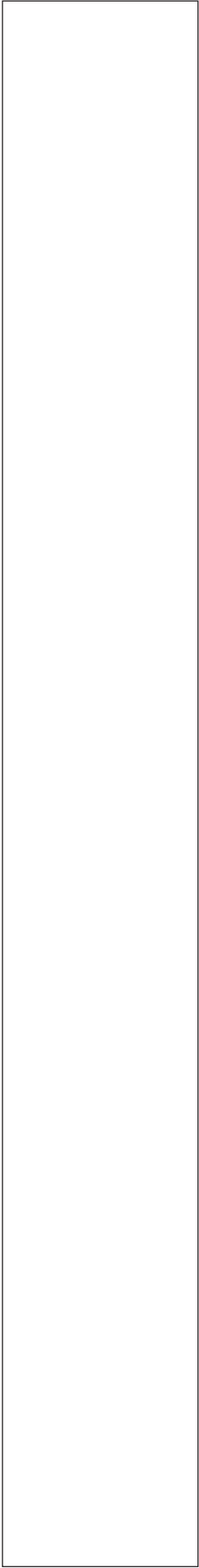

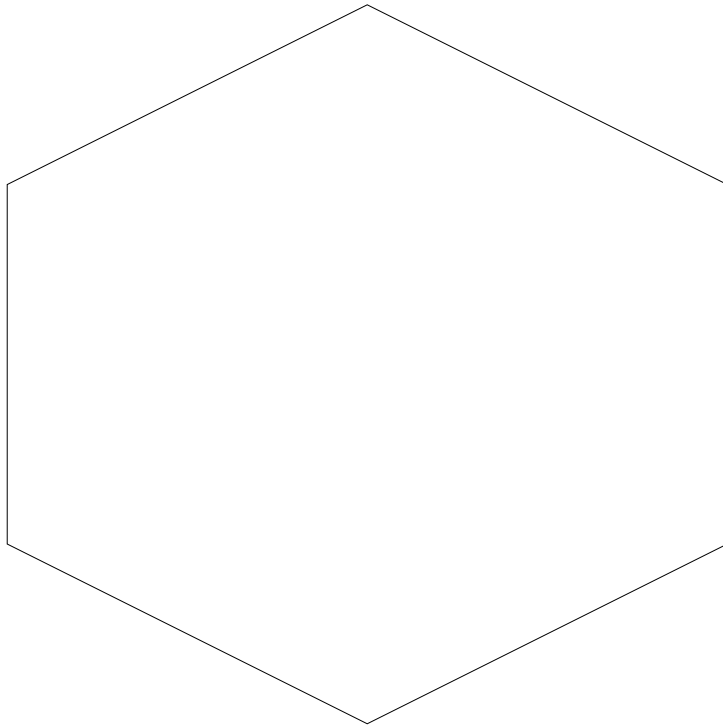

Plain center option that would make for a fun twist.

